

1  
9  
5  
6

JUNE

# TEXAS ARCHITECT

OFFICIAL PUBLICATION OF THE TEXAS SOCIETY OF ARCHITECTS

## IN THIS ISSUE

- ◆ Architects Bring Beauty To Industry
- ◆ False Economy In The Schoolhouse
- ◆ Church Seminar In Dallas



Unit "A" of the Trinity Methodist Church at Beaumont has been selected by members of the Southeast Chapter, AIA as representative of recent work in the Chapter area. Architects: Livesay & Livesay, TSA-AIA, Beaumont.

An exploded view diagram of various acoustical fastening members, including I-beams, channels, and clips, arranged in a descending staircase pattern from top-left to bottom-right. A thick black horizontal bar is positioned behind the main title.

# ACOUSTICAL FASTENING MEMBERS

**proved design**

*Made in Texas*

**low freight rates**

Kelley's acoustical fastening members offer a proved design backed up by one of the Southwest's largest stamping and roll forming companies. You get more than a design that is engineered to do the job. You get more than on-time delivery. Your clients benefit from low freight charges. Made in Houston, so you can be sure of good delivery, plus the advantage of lower delivery costs. Write for descriptive folder, or ask to have a Kelley engineer discuss acoustical fastening members with you.

*Kelley*

**MANUFACTURING CO.**

4800 CLINTON DRIVE — HOUSTON

134 Ellis Bean Street — San Antonio

9100 Ambassador Row — Brook Hollow Industrial District — Dallas

How to

# Shock-Proof Concrete

Is Indicated by the Results of...

## Impulse Tests of Concrete Beams At Carnegie Institute of Technology

PHOTO AT INSTANT  
OF LOAD APPLICATION

Exposure 1/200 Second

Showing results of identical  
thrusts, concentrated at center  
of span, in less than 1/20th  
second.

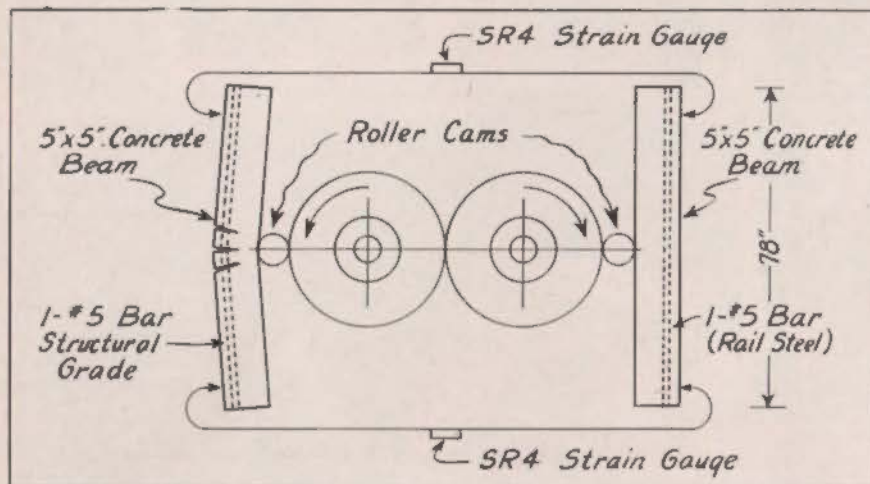

SCHEMATIC DRAWING  
OF METHOD OF TEST

Flywheel speed — 167 r.p.m.

Roller cams were released  
simultaneously by a trigger.

For the complete story, see article by F. T. Movis and F. A. Richards on "Impulse Testing of Concrete Beams" in Sept. 1955 issue of Journal of the American Concrete Institute

Reprints of Bulletin on IMPULSE TESTING OF CONCRETE BEAMS (A.C.I. Title No. 52-8) Available on Request



**TEXAS STEEL CO.**  
FORT WORTH, TEXAS

Member Rail Steel Bar Association

Whitest by  
*Any*  
 standard

The extreme whiteness of Trinity White Cement is obtained by selection of raw cement-making materials which are remarkable for absence of color. There is no off-color cast in Trinity White to detract from the beauty of the finished structure.



Trinity is the *whitest* white cement judged by any standard. It is whitest in the bag . . . whitest in the mix . . . whitest in the finished job! You can see the extra whiteness with the naked eye! Trinity White is a true portland cement. It meets all Federal and ASTM specifications. Use it for architectural concrete units; stucco, terrazzo; cement paint; light-reflecting surfaces; mass or contrast; or wherever the purity of white and the purity of color tints is desirable in concrete or masonry. Trinity Division, General Portland Cement Co.



as white  as snow  
 . . . plain or waterproofed

*Trinity White*  
 THE WHITEST WHITE CEMENT

A Product of GENERAL PORTLAND CEMENT CO. • Chicago • Dallas • Chattanooga • Tampa • Los Angeles

## INSIDE THE TEXAS ARCHITECT

Dallas Church Seminar.....	4
Beaumont Selection.....	9
Jeff Johnson.....	5
News of the Chapters.....	10

Official Publication of  
**THE TEXAS SOCIETY OF ARCHITECTS**  
 The Texas Regional Organization of the  
 American Institute of Architects  
 David C. Baer, AIA-TSA..... Editor  
 1200 Bissonnet, Houston  
 John G. Flowers, Jr.,..... Managing Editor  
 Perry-Brooks Building, Austin  
 Clark, Kirksey & Company  
 Editorial Counselors  
 1731 Bissonnet, Houston

**PUBLICATION BOARD**  
 David C. Baer, Chairman, TSA-AIA Houston  
 Lee R. Buttrill, TSA-AIA..... Beaumont  
 Max Brooks, TSA-AIA..... Austin  
 Terrell R. Harper, TSA-AIA..... Dallas  
 Albert S. Golemon, TSA-AIA..... Houston  
 Nolan Barrick, TSA-AIA..... Lubbock  
 Edward L. Wilson, TSA-AIA..... Fort Worth

**TEXAS SOCIETY OF ARCHITECTS OFFICERS**  
 R. Max Brooks..... President  
 203 Perry-Brooks Building, Austin  
 Fred J. MacKie..... Vice-President  
 2713 Ferndale, Houston  
 Reginald H. Roberts..... Second Vice-President  
 2600 McCullough, San Antonio  
 Louis F. Southerland..... Secretary-Treasurer  
 602 West Avenue, Austin  
 John G. Flowers, Jr.,..... Executive Director  
 327 Perry-Brooks Building, Austin

### DIRECTORS

O. L. Puckett..... Big Spring  
 Panhandle Chapter, A.I.A.  
 Winfred O. Gustafson..... Austin  
 Central Texas Chapter, A.I.A.  
 Terrell R. Harper..... Dallas  
 Dallas Chapter, A.I.A.  
 Robert P. Woltz, Jr.,..... Fort Worth  
 Fort Worth Chapter, A.I.A.  
 Charles Huie, Jr.,..... San Antonio  
 San Antonio Chapter, A.I.A.  
 Walter E. Wilde..... Corpus Christi  
 Coastal Bend Chapter, A.I.A.  
 Thompson McCleary..... Houston  
 Houston Chapter, A.I.A.  
 William C. Baxter..... Weslaco  
 Lower Rio Grande Chapter, A.I.A.  
 William G. Wuehrmann..... El Paso  
 El Paso Chapter, A.I.A.  
 William E. Nash..... Bryan  
 Brazos Chapter, A.I.A.  
 David S. Castle..... Abilene  
 West Texas Chapter, A.I.A.  
 R. C. Heartfield..... Beaumont  
 Southeast Texas Chapter, A.I.A.  
 Albert S. Golemon..... Houston  
 A.I.A. Director  
 Glynn L. Harris..... Wichita Falls  
 North Texas Chapter, A.I.A.

Published monthly by the Texas Society of Architects in Houston. Subscription price, 50c per year, in advance. Copyrighted 1951 by the T.S.A., and title registration applied for with the U. S. Patent Office.

Editorial contributions, correspondence, and advertising invited by the Editor. Due to the nature of the publication, editorial contributions cannot be purchased. Publisher gives permission for reproduction of all or part of editorial material

herein, and requests publication credit be given THE TEXAS ARCHITECT, and author of material when indicated. Publications which normally pay for editorial material are requested to give consideration to the author of reproduced by-lined feature material.

Appearance of names and pictures of products and services in either editorial copy or advertising does not constitute an endorsement of same by either the Texas Society of Architects or the American Institute of Architects.

## FALSE ECONOMY IN THE SCHOOLHOUSE

A number of architectural publications have editorialized recently on the false economies inherent in failing to use full architectural services in school construction and remodeling. A particularly compelling argument is that advanced by Douglas Haskell of the ARCHITECTURAL FORUM.

We quote Mr. Haskell:

"Of course there is no money to waste, but many economy proposals lose more at the bung than they save at the spigot. Architects' fees, for instance, have been the target of excited citizens' meetings weak in arithmetic.

"Figure this: (the physical school plant) . . . . costs a scant 15% of the annual school budget, and half of this is operation and maintenance, leaving 8% for construction.

"Consequently, if you cut the architects' fee from, say, 6% to 5%, you have achieved a net annual saving of just 0.08% or 8/10,000 in the education of your children. Is that worth the battle?"

Mr. Haskell then points out that penny-pinching, which fails to make it possible for the architect to pay his men for a really first-class job, may cost many times the saving.

When industry wants to achieve a cut in costs without a corresponding loss in quality, Mr. Haskell states, "they pay experts a premium for the hard job of figuring it."

"Far school economy," he concludes, "architects' fees should be raised, not lowered, as they achieve economy."

## The President's Letter

By

R. Max Brooks

TSA-AIA

President,  
 Texas Society  
 of Architects



While returning from the national AIA convention in Los Angeles, I was reading the current issue of a national pictorial weekly which circulates in the millions.

One of the principal articles in this issue emphasizes by means of beautiful colored pictures and accompanying text, the striking change that U. S. architecture has helped to bring about in American factories and industrial installations. Page after page shows the factory need not be either grimy or dull. Instead, it can be a functionally efficient building and one that actually inspires employees at all levels to better, happier and more meaningful doys at work.

Many of you probably saw this issue of LIFE to which I refer. Is it not apparent that the structures shown, in their beautiful settings, are better, safer and more productive places in which to spend the tremendous percentage of our lives devoted to work?

U. S. architects are now very well established in industry, whereas a generation or so ago the general public thought of the architect as a somewhat unknown professional man who was occupied primarily in designing public buildings and homes for the extremely wealthy. They have become established because industry, as well as the public, has found that the use of an architect for virtually any structure is a sound investment which pays off by adding hard cash value far above the architect's fee, while increasing functional utility.

The LIFE article is a reminder of how the architect is also serving industry by providing a more attractive environment, often a really beautiful one, which adds great intangible values as well as increased safety and employee satisfaction.

## June 7-8 Dallas Seminar On Church, College Architecture

More than 120 new church buildings costing a total of \$31,950,000 will be erected by churches in the Baptist General Convention of Texas during the coming year, officials said recently in Dallas.

The denomination also expects to spend an additional \$28,000,000 for new college and university facilities during the next nine years.

The convention has now employed a full-time architectural consultant to counsel with pastors and laymen and enlisted the aid of a six-man committee to help plan the work.

A seminar on church and college architecture will be held June 7 and 8 at the First Baptist Church in Dallas, to study various phases of architecture as they pertain to Baptist work. Texas architects have been invited. Working on arrangements for the seminar are Ben E. Christian of Corpus Christi and Harold Calhoun of Houston.

Dr. Forrest C. Freezor, executive secretary for the BGCT, recently said

Texas Baptist will need more than 3,000 new churches during the next 20 years, 120 of them within the next 12 months.

### TWO CHURCHES EACH WEEK

The denomination is growing at the rate of two new churches each week and is expected to have more than 5,200 congregations in the state by 1975.

The churches' total gifts for all causes this year are expected to exceed \$71,000,000, of which approximately 13 per cent will be spent on church building payments 27 per cent on new buildings and equipment and 5 per cent on maintenance and building insurance.

Texas Baptist Sunday Schools have doubled in enrollment during the past 12 years. More than 23,000,000 square feet of building space will be needed for future growth in that area of work alone. Old buildings that become unusable will also have to be replaced.

From 1949 through 1954, Southern Baptists churches over the country as a whole increased the value of their church property by 112 per cent. More than \$227,000,000 worth of this property was owned by the churches in Texas. Indebtedness against the churches' property averaged only 12 per cent of the value.

It is to help meet the need for new buildings, remodeled buildings, additions and other facilities that Texas Baptists have employed the first architectural consultant used by any state in the Southern Baptist Convention.

### DUTIES OF REV. CALDWELL

The Rev. J. W. Caldwell, a pastor for 17 years, has led in four building programs in different cities. He became associated with the BGCT Church Loan Department in 1952. From March, 1954, through October 1955, he worked jointly with both that department and the Department of Direct Missions as a consultant in building and financing. He became an associate in the department only a short time ago.

Caldwell's specific duty is to counsel with church leaders in helping them erect, repair or extend their plants. He also surveys existing buildings to de-

*(Continued on page 6)*

ADVERTISED IN

**LIFE**

Better Homes  
and Gardens

Service Makes the Difference

*Lone Star*  
**BRICK COMPANY**



TRADE MARK • SCPI

7007 Grapevine Hgwy.  
Fort Worth, Texas  
AT 4-4622 AT 4-1340

In Abilene In Wichita Falls  
301 S. Fifth 3907 Lawrence Road  
2-8952 7-6422



MOTION CARRIED!  
 AGREED THAT WE ACCEPT  
 THE RECOMMENDATION OF OUR  
 ARCHITECTURAL CONSULTANT!  
 MEETING ADJOURNED!



KIRK, I WAS IN  
 AGREEMENT WITH YOUR  
 EXPLANATION ABOUT DUPLICATE  
 PLANS BEING FALSE  
 ECONOMY. YOU REALLY  
 CONVINCED ME TONIGHT!

THANKS,  
 MR. JACKSON!

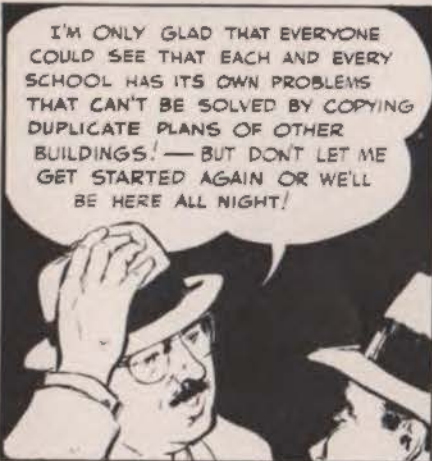

I'M ONLY GLAD THAT EVERYONE  
 COULD SEE THAT EACH AND EVERY  
 SCHOOL HAS ITS OWN PROBLEMS  
 THAT CAN'T BE SOLVED BY COPYING  
 DUPLICATE PLANS OF OTHER  
 BUILDINGS! — BUT DON'T LET ME  
 GET STARTED AGAIN OR WE'LL  
 BE HERE ALL NIGHT!



THE BOARD REALLY  
 APPRECIATED YOUR  
 GOING INTO IT! YOU  
 SAVED US FROM  
 MAKING A BIG  
 MISTAKE!

GOOD!  
 I'LL GET THE  
 INVITATIONS  
 OUT TO THE  
 ARCHITECTS  
 TOMORROW AND WE'LL  
 START INTERVIEWING  
 RIGHT AWAY! GOOD  
 NIGHT!

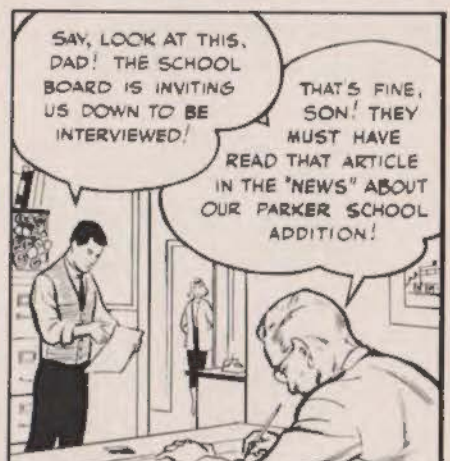

SAY, LOOK AT THIS,  
 DAD! THE SCHOOL  
 BOARD IS INVITING  
 US DOWN TO BE  
 INTERVIEWED!

THAT'S FINE,  
 SON! THEY  
 MUST HAVE  
 READ THAT ARTICLE  
 IN THE 'NEWS' ABOUT  
 OUR PARKER SCHOOL  
 ADDITION!



HEY, I HEARD  
 THAT — AND IT'S  
 WONDERFUL,  
 JEFF! YOUR  
 FIRST JOB!

HI, SWEET!  
 DON'T YOU  
 GO COUNTING  
 ANY CHICKENS  
 YET THOUGH!  
 IT'S ONLY AN  
 INTERVIEW!

TAKE OUR  
 EXPERIENCE  
 RECORDS OVER  
 AND GET THE  
 JOB FOR US  
 SON!



I'LL WAIT  
 HERE! LUCK  
 DARLING!

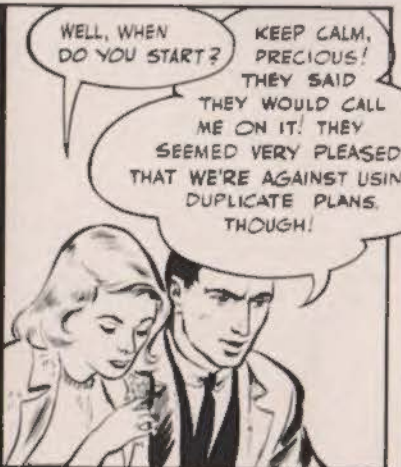
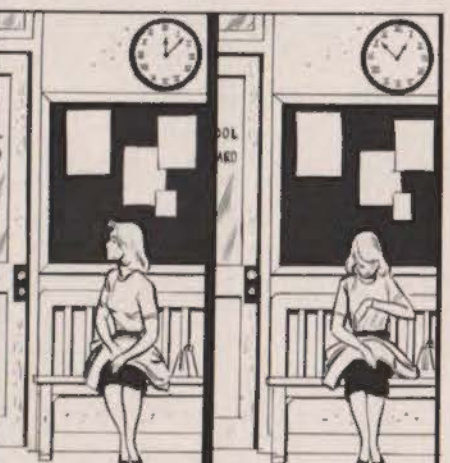

WELL, WHEN  
 DO YOU START?

KEEP CALM,  
 PRECIOUS!  
 THEY SAID  
 THEY WOULD CALL  
 ME ON IT! THEY  
 SEEMED VERY PLEASED  
 THAT WE'RE AGAINST USING  
 DUPLICATE PLANS,  
 THOUGH!



TEN DAYS LATER

WE'VE GOT IT!  
 WE'VE GOT IT! THEY  
 WANT US TO DESIGN  
 THE SUGAR HILL  
 HIGH SCHOOL!

WHOA! PUT  
 ME DOWN YOU  
 WILD MAN

OF COURSE  
 WE GOT IT!  
 FELT ALL ALONG  
 WE WOULD!  
 HMMPH! YES...  
 CONGRATULATIONS,  
 SON! THAT'S A  
 BIG JOB YOU GOT  
 FOR US!

● *When you desire*  
**SERVICE**  
*in the form of*  
**FURNITURE INFORMATION**  
*or collaboration in*  
**INTERIOR LAYOUTS**  
*along with*  
**GRAPHIC PRESENTATION**  
*you- or your*  
**CLIENT**  
*are welcome to our*  
**SHOWROOM** *and*  
**DESIGN DEPARTMENT**  
*any time, with*  
**NO OBLIGATION**  
*Plan to visit ●*  
**FINGER CONTRACT**  
 3131 Calhoun, Houston: AT 3441

## Water Colors by Architects on Exhibition

The School of Architecture of The University of Texas held a special exhibit of "Water Colors by Mid-West Architects" in the Architecture Building from April 12 to April 24, as a special attraction during Texas Architects' Week.

This collection of watercolors by six-

teen architects from Nebraska, Missouri, Kansas, Colorado, and Texas clearly demonstrated the versatility of the medium as well as the excellent artistic talent of the architects represented.

The group of paintings has been collected and prepared for circulation.

## Clay Products Association Makes Cash Awards To Champion Apprentices

The champion apprentice bricklayers of Texas are Arnold L. Keel of Fort Worth and Robert R. Ruzzamenti of Dallas. Mr. Keel and Mr. Ruzzamenti won the title of champion in Fort Worth in a contest sponsored annually by the bricklayers union, building contractors, brick and tile manufacturers and the U. S. Bureau of Apprenticeship. Contestants are judged on excellence of craftsmanship and skill in building a typical brick wall.

Mr. Keel was sponsored by the Brick Masans and Plasters International Union, Local Number Six of Fort Worth and Mr. Ruzzamenti was sponsored by the Local Number Five of Dallas. Both men were in Seattle, Washington on April 20-25.

The Clay Products Association of the Southwest, regional trade group of brick and tile manufacturers made a \$100.00 cash award to each winner to defray travel expenses to the Pacific Northwest. Two alternate winners were named, Robert Smith, sponsored by Local Number Seven of Houston and Charles A. Thomas, sponsored by Local Number 14 of Sherman.

## DALLAS CHURCH SEMINAR

(Continued from page 4)

termine a church's maximum capacities, helps determine what buildings are needed and what the church will be financially able to afford, suggests master plans for long-range programs and provides information on registered architects who have an interest in the Baptist program. Caldwell does not prepare floor sketches or working drawings, or in any way perform architectural services.

### COMMITTEE MEMBERS LISTED

The committee which has been elected to work with him include Mr. Christian, W. H. Souther, educational director for the First Baptist Church in Dallas; the Rev. L. L. Morriss, pastor of the First Baptist Church in Midland; Mr. Calhoun, Adam A. Bliss, TSA-AIA, Dallas; and Herbert Brasher, TSA-AIA, Lubbock. Ex-officio members include Dr. Feezor and Hooper Dilday, Sunday School associate secretary for the BGCT.

The theme of the June 7-8 seminar in Dallas will be "building for the future." Speakers will include most of the architectural committee members and 10 denominational leaders and workers for the Baptist General Convention of Texas.

Eliminate NOISY, DESTRUCTIVE **WATER HAMMER**

WITH  **SHOCK ABSORBERS**

Water hammer in pipe lines causes untold annoyances and damage every day. The destructive vibration is particularly disturbing in hospitals, hotels, schools, libraries—as well as in homes. In factories, it results in loosened hangers, broken pipe fittings, failure of valves and gauges. The Josam Shock Absorber gives you "hospital quiet" in all plumbing lines. Due to the specially designed Absorbo tube and insert, the Josam Shock Absorber dissipates the thrust and impact of the water entering the tube. As the shock recedes, the tube and insert regain their original form, ready to receive the next impulse.

Specify the new Josam Shock Absorbers and permanently remove the destructive and annoying water hammer.

Call or write for Manual S on Shock Absorbers.

**JOSAM MANUFACTURING CO.**

MICHIGAN CITY, INDIANA

District Representatives



**JOE P. DILLARD**  
 1531 Edison St.  
 Dallas, Texas  
 RI 9691

**R. B. ARNOLD**  
 1309 Anita Ave.  
 Houston, Texas  
 JA 3074







# COLOR

## YOUR BEST SELLING FEATURE

What's the most exciting thing in home planning today? Our fresh new attitude to color, of course—particularly in bathrooms where color is so important to smart, attractive salable homes.

Briggs Beautyware fixtures can make your bathrooms sparkle. And Briggs employs professional color styling for smartest, attractive decor. For example, cool green fixtures surrounded by nature tones of yellow, chartreuse and red, is one of several unusual treatments possible with Beautyware Sea Green.

And all Beautyware fixtures have outstanding selling features for your prospects. In every way Briggs Beautyware will reflect your professional taste in colors—and quality in both fixtures.

In Beautyware Sea Green—

Marquette Tub, Carlton Closet, Twin Lowell Lavatories

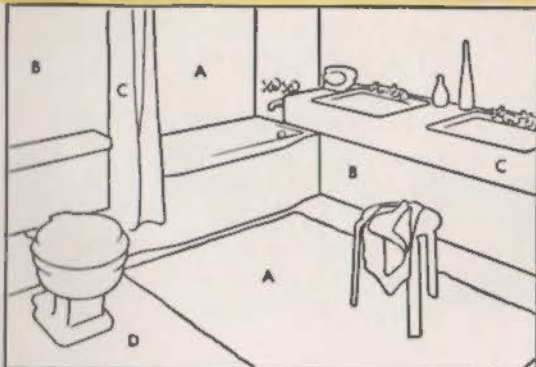

Color styling by Howard Ketcham, nationally famous color engineer

A-Sea Green B-Chartreuse C-Flame Red D-Yellow  
Other decorator colors compatible with Sea Green are: Beige, Gray-Blue, Rose, Violet-Blue, Pale Green, Off-White

# BRIGGS BEAUTYWARE

BRIGGS MANUFACTURING COMPANY, 300 BUHL BUILDING, DETROIT 26, MICH.

# the WINDOWS

MAINTENANCE MEN CAN TURN THEIR BACKS ON!



CARL H. STAUTZ  
ARCHITECT

TYPICAL CLASSROOM • BRENHAM ELEMENTARY SCHOOL  
BRENHAM, TEXAS

NO PAINTING  
REQUIRED!

... INSIST ON

# ALUMAR

REG. U. S.  
PAT. OFF.

## Aluminum Windows

- Smart appearance
- Easy operation
- Economical maintenance

**R. H. FOLMAR COMPANY**

manufacturers  
AUSTIN, TEXAS

... as illustrated in Sweet's

SWINGING DOORS • SLIDING PANELS • CASEMENT WINDOWS • PROJECTED WINDOWS

### Architecture Library Requests Back Issues to Complete Files

Catherine S. Franklin, librarian of the Architecture Library at the University of Texas, has requested that TSA members who may have duplicates of the following issues of the TEXAS ARCHITECT contribute them in order to complete library files:

1950: March-April, July, September, October, November.

1951: January, March, April.

1952: July, September, November.

1953: February, October, November, December.

Members are asked to comply with

this request if they have duplicate copies or if they no longer wish to keep back issues.

### Formal Architectural Education Followed By Internship

Curricula of our best schools of architecture emphasize the development of the student's potential and provide training in the fundamentals of the Arts and Sciences which can best be secured in school, leaving the application of these fundamental or basic theoretical studies to be acquired through experience under the guidance of the practicing architect.

### Philip D. Creer Named Director Of U. T. School of Architecture

Philip D. Creer of Providence, R. I., senior partner in the architectural firm of Kent, Mather, Cruise & Aldrich and head of the Department of Architecture, Rhode Island School of Design since 1933, has been named director of the School of Architecture & Planning at Texas University. The post had been vacant since the resignation of Horwell H. Harris in 1955.

A graduate of the University of Pennsylvania, Mr. Creer was an instructor there from 1928-31 and head of the Department of Architecture at the Wanamaker Institute in Philadelphia from 1927-1932.

Mr. Creer has been practicing architecture as a principal since 1935. He became a corporate member of the AIA in 1941 after seven years as an associate.

The new head of the UT School of Architecture has been prominent in AIA affairs and in community organizations. A former president of the Rhode Island Chapter, AIA, he served on the national AIA board from 1952-1955 and on a number of state and national committees. His civic work has been on a number of committees including groups for crippled children and adults, historic buildings and on advisory boards to city and state government.

### Design By Beaumont Firm Selected For Exhibition At Georgia Tech Event

Combs Hall at Lamar State Hall, designed by Stone & Pitts, TSA-AIA of Beaumont, has been selected by a jury to be exhibited in "A Half Century of Architectural Education," which opened at Georgia Tech on May 27.

Members of the jury were Joseph Hudnut, former dean of the Graduate School of Design at Harvard University; Francis P. Smith and Paul M. Hefernan of Georgia Tech; and Roy Jones, professor emeritus of the School of Architecture at the University of Minnesota.

The Atlanta exhibition, in honor of Harold Bush-Brown, retiring head of the School of Architecture at Georgia Tech, will be sent on a special tour by the Smithsonian Institute. Almost 500 entries were submitted the jury for the Georgia Tech selections.

**Southeast Texas  
Chapter, AIA  
Representative Selection:**

UNIT A, TRINITY METHODIST CHURCH,  
BEAUMONT, TEXAS

CLIENT:  
TRINITY METHODIST CHURCH

ARCHITECT:  
WALLACE B. LIVESAY AND TOM B.  
LIVESAY

MECHANICAL ENGINEER: MICHAEL  
BARR

CONTRACTOR: CHRIS SMITH, INC.

Building Includes:

**Fellowship Hall:** Presently being used as Sanctuary and Fellowship Hall. This area provides a seating capacity of 600 when used as a Sanctuary.

**Kitchen:** Directly off Fellowship Hall with all stainless steel equipment and facilities.

**Classroom Wing:** The classroom wing includes classrooms used at present for general use, and the Minister's study and general church offices. When the master plan is further developed with the addition of other educational facilities, this wing will revert to its intended use, that of a childrens classroom wing, housing children from crib age through kindergarten age.

**Parking Area:** Size sufficient to accommodate over 300 cars. This unit of the Church is built on a 12 acre site in a new residential subdivision of Beaumont. On full development of the master plan the site will contain this present Unit A and parking area plus 3 additional building units, specifically one unit containing additional educational facilities, a sanctuary unit, a chapel unit, and sizeable area of land devoted to recreation.

Since parking facilities have become a consideration of major proportions, a site was purchased of sufficient size to permit on site parking facilities for something over 300 cars, and the plan was developed with the parking area as the focal point.

The main access to the Fellowship Hall & kitchen area is a two lane circular drive off a side street. This drive is protected by a canopy leading to the entrance vestibule providing all weather shelter for persons entering or leaving the building. One feature of this entrance that has proven to function very successfully is the use of low pitched ramps rather than steps, allowing persons confined to wheel chairs comfortable and easy access.



**Southeast Chapter Winner**

An interior view of the Trinity Methodist Church, Unit "A", at Beaumont, selected by the Southeast Chapter, AIA as representative of recent work in the Chapter area.

Face brick were used extensively both as an exterior and interior wall surface material. The structure is mainly laminated wood beams and arches in the Fellowship Hall and laminated wood beams in the classroom wing, for the most part left exposed. Other

finishes include: Terrazzo floors, asphalt tile floors, ceramic tile floors and walls, plaster walls, various wood paneling, and acoustical tile ceiling.

The completed unit has a five zoned air conditioning system, for maximum flexibility in various departmental uses.



**ALL-WETHR  
WINDOW  
UNITS**



**SPECIFY WINDOWS WITH  
IDENTIFIED QUALITY**



IDEAL All-Wethr Windows bear the Quality Approved Seal of the American Wood Window Institute. They meet or exceed the strict standards of the Institute covering quality of materials, proper assembly, air infiltration, preservative treat and efficiency of balancing devices.

**IDEAL MILLWORK IS SOLD AT RETAIL LUMBER YARDS**

## News Of The Chapters

**WEST TEXAS:** The first meeting ever held in Odessa drew a record Chapter attendance. John G. Flowers, Jr., executive director of TSA, spoke on "Architectural Law, Ethics & Practice."

**DALLAS:** Richard Kelly, president of the New York City firm of Kelly & Thompson, lighting consultants, spoke on "The Use of Light". Mr. Kelly, using slides to illustrate his remarks, described the use of light for maximum effect in a structure. He showed recent jobs including General Motors Technical Center, Detroit; Bonwit-Teller's Boston store; the Desert Inn in Las Vegas; and the Museum of Modern Art in New York.

Albert Golemon, TSA-AIA of Houston, regional AIA director, was a guest. He discussed the AIA convention agenda and TSA participation. The following delegates were named: Terrell Harper, chairman; Ralph Bryan, J. Murrell Bennett; Arthur Thomas; George Dahl; Harris Kemp; Thomas Broad, Donald Nelson; Grayson Gill; Harold Prinz; and LaVere Brooks.

**HOUSTON:** James Chillman, Jr., professor of architecture at Rice Institute

and director emeritus of the Houston Museum of Fine Arts, spoke on "Architecture—Past & Present". Walter Rolfe, FAIA, was master of ceremonies at the TAW dinner meeting. Eight Chapter members who have been practicing architecture for 50 years or more were presented.

### INDEX TO ADVERTISERS

Airtemp Sales Corporation	Cover III
Briggs Manufacturing Corp.	7
Cameron Lumber Company	9
Dezendorf Marble Company	10
Finger Furniture Contract	6
Folmar, R. H. Company	6
Josam Manufacturing Company	10
Kelly Manufacturing Company	C 11
Lone Star Brick	4
Rheem Manufacturing Company	C IV
Texas Bitulithic Company	10
Texas Steel Co.	1
Trinity White	2

Manufacturers of 24 Colors for Terrazzo and Roofing.

Featuring Sparkling Texas White.

## DEZENDORF MARBLE COMPANY



2900 E. 17th ST. P. O. BOX 6032 AUSTIN, TEXAS

# 50

years of experience

stand behind every job!

**asphalt  
and concrete**

Residential • Industrial  
Streets • Parking  
Lots • Drive-Ins

The skill and experience gained in 50 years of better paving throughout Texas and the Southwest are your guarantee that if it's paving by Texas Bitulithic Company, it's paving you can depend on to last. Let one of our salesmen-engineers show you how paving by Texas Bitulithic Company can save you money.



## BITULITHIC COMPANY



**AIR CONDITIONING**

**pioneered by Chrysler  
engineered by Chrysler  
to offer you the most  
versatile line of air  
conditioning & heating  
equipment available today  
for residential & commercial  
building**

**Air Accessories, Inc.**

1400 Henderson  
Fort Worth, Texas

**Airtex, Inc.**

1007 Waugh Drive  
Houston, Texas

**Baker Engineering Co.**

P. O. Box 543  
Lubbock, Texas

**Caperton Refrigeration Co.**

P. O. Box 3222  
Tyler, Texas

**Low-Temp Distributors**

125 Lamar Street  
San Antonio, Texas

**Royalair Distributors**

2122 Olive Street  
Dallas, Texas

**United Electric Service Co.**

500 Galveston  
Wichita Falls, Texas

**Walsh Engineering Co.**

Highway 75 North  
Sherman, Texas

**for complete  
information**

**CALL THE  
AIRTEMP  
DISTRIBUTOR  
IN YOUR AREA**

TEXAS ARCHITECT  
Box 1733  
FORT WORTH, TEXAS  
Form 3547 Requested

Section 34.66 P. L. & R.  
U. S. POSTAGE  
**PAID**  
FORT WORTH, TEXAS  
PERMIT No. 2037



**RHEEM has  
scooped 'em all  
for '56**

with the new  
revolutionary

**RHEEM AIRE**

**CENTRAL AIR CONDITIONER**

**... 95% more efficient**

you can rely on



**MANUFACTURING COMPANY**

1025 Lockwood Dr. Houston, Texas